

REVISIONS		
DATE	NAME	LICENSE #

SHEET 8

SHEET 10

SHEET 6

SHEET 11

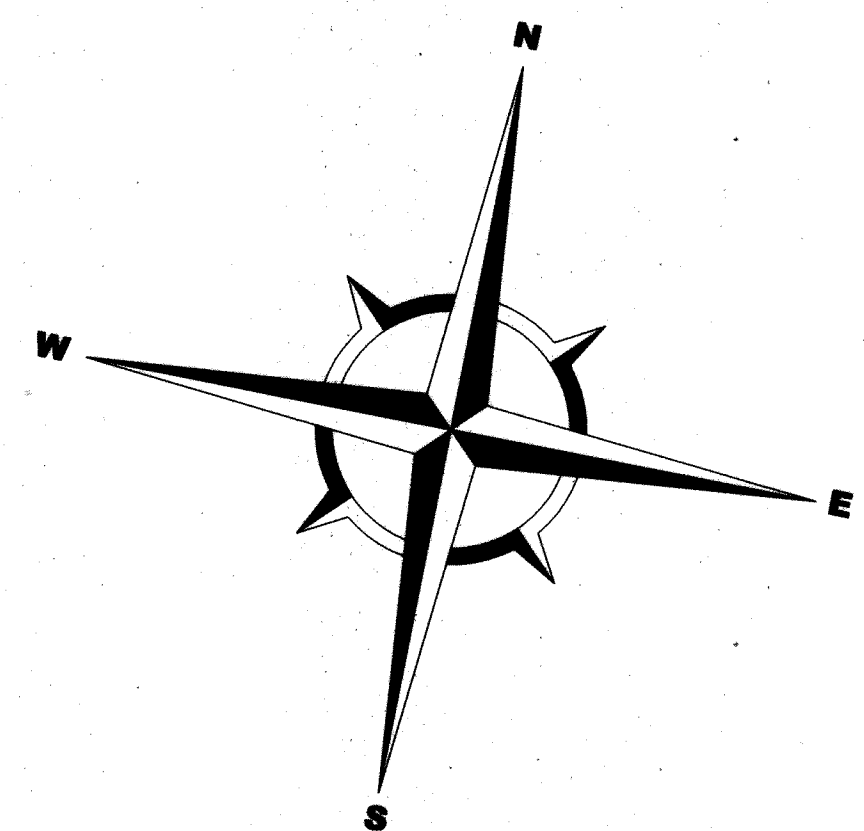
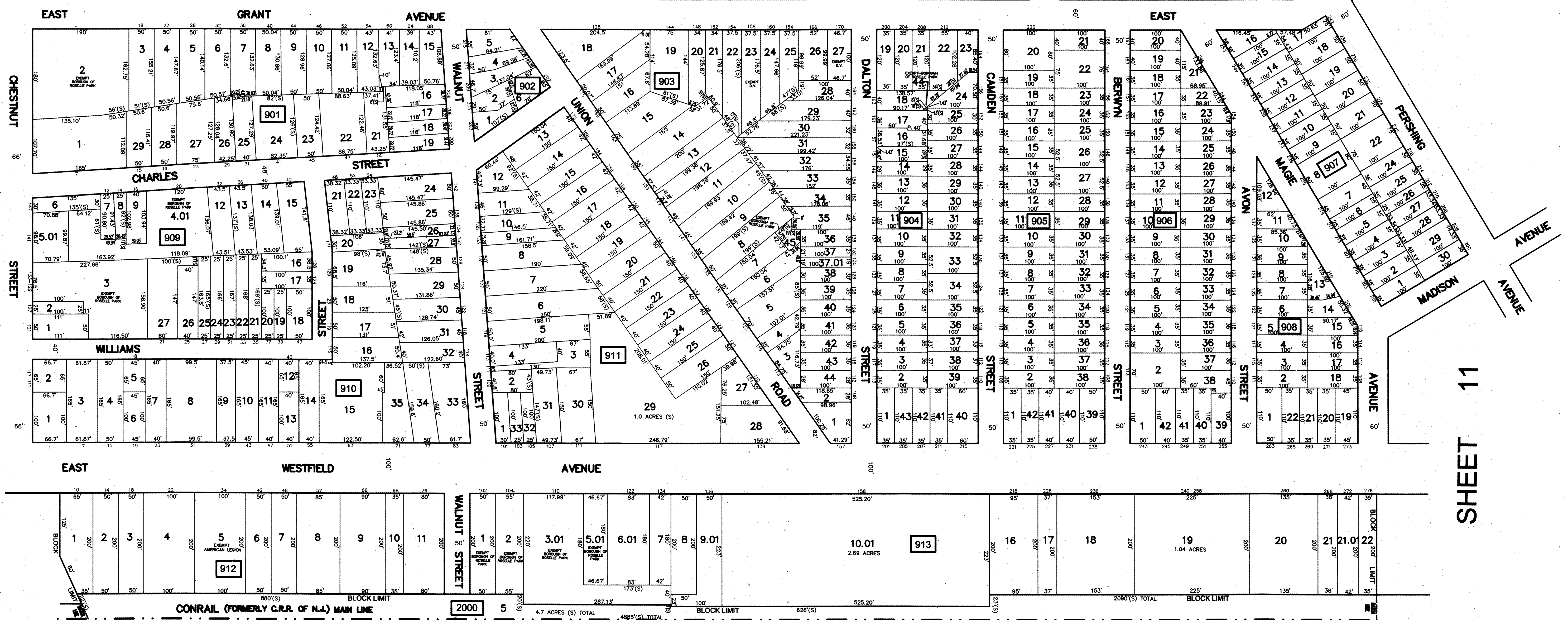

BOROUGH OF ROSELLE
 COUNTY OF UNION

NEW JERSEY DEPARTMENT OF THE TREASURY
 DIVISION OF TAXATION
 PROPERTY ADMINISTRATION TAX MAP SECTION
 APPROVED AS A TAX MAP PURSUANT TO THE
 AUTHORITY OF N.J.S.A. 54:1-15 & N.J.S.A. 54:50-1
 FOR THE DIRECTOR, DIVISION OF TAXATION
 See Division, CTA Supervising Field Rep
 See Division, CTA Supervising Field Rep
 DATE: **AUG 28 2014** SERIAL NO. **1044**

TAX MAP
BOROUGH OF ROSELLE PARK
 UNION COUNTY, NEW JERSEY
 SCALE: 1" = 100'
 MICHAEL J. NEGLIA, P.E. P.L.S. P.P.
 NEW JERSEY LICENSE NUMBER 38604
 34 PARK AVENUE, LYNDHURST NEW JERSEY
 TO SHOW CONDITIONS AS OF SEPTEMBER 1, 2013

THIS SHEET HAS BEEN DRAWN USING COMPUTER AIDED DRAFTING (CAD).